

**United States Department of the Interior
National Park Service**

**National Register of Historic Places
Inventory—Nomination Form**

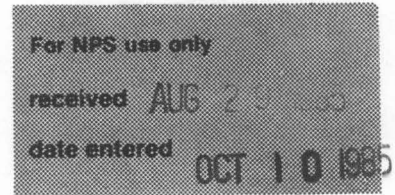

Continuation sheet

Item number

Page

East Michigan Avenue Historic District

1. Name: East Michigan Avenue Historic District
2. Location: the District includes the north side of E. Michigan (301-321); the adjoining three houses on Maple (99-103); 300 E. Michigan; and 217, 300 and 302 E. Henry, Saline, MI.
3. Classification: district, private, occupied, residential and commercial
4. Property Owners List: (unless otherwise indicated, all buildings are private residences with owners address the same as the address of the property, and with a Saline, Michigan, zip code of 48176)

300 E. Michigan
Bliss A. Curtiss

301 E. Michigan
Residence and Commercial Bldg.
James W. Robison

303 E. Michigan
Pauline Fosdick

305 E. Michigan
Fletcher Disauteis

307 E. Michigan
Dennis and Leslie Mickalak

309 E. Michigan
c/o Andrus Davis Co.
201 E. Washington St.
Ann Arbor, MI 48107

311 E. Michigan
Donald Sutherland

313 E. Michigan
Thomas G. McCartney

315 E. Michigan
Verna Holmes

317 E. Michigan
Edward Cammett

319 E. Michigan
Richard G. and Joan Minick
5821 Saline-Ann Arbor Rd.

321 E. Michigan
Ralph E. Bowen
210 Wheeler Ct.

99 N. Maple
Kenneth and Dorothy Jeppesen

101 N. Maple
Eugene L. Fisher, Jr.

103 N. Maple
Donald A. Fedor

217 E. Henry
Robert Steward

United States Department of the Interior
National Park Service

National Register of Historic Places
Inventory—Nomination Form

For NPS use only

received

date entered

Continuation sheet

Item number

Page

300 E. Henry
Dr. D. E. Garrison
205 Davenport

302 E. Henry
Richard Frank

7. Description: good; altered; original

The East Michigan Avenue Historic District comprises roughly 16 acres of the tree-shaded residential neighborhood clustered around the National Register landmark of the William Davenport House (300 E. Michigan, photos # 11, 16). The irregularly shaped District includes 18 wood-framed structures and 9 well-preserved barns and carriage houses, all of which contribute to the District's historic visual character (photos 11-15). The high design quality of these Queen Anne, Second Empire, Colonial Revival, and Bungalow style buildings is marred only by alterations to porches and occasional application of siding. Despite alterations, the District retains the architectural ambience of the the 1870s-1920s period during which these buildings were constructed. Uses are all residential, with the exception of the Funeral Parlor at 301 E. Michigan.

Michigan Avenue serves as the central axis for the District. The lots to the north of Michigan Avenue (including the Maple Street properties) are of fairly uniform size, with even, wide setbacks and yards with mature shrubbery and shade trees. White or light-colored paint covers most homes, and because several in the Queen Anne/Colonial Revival style were constructed by Elwood Rogers, there is a certain unity of scale and detail (photos #13, 19, 20). Some of the homes on Michigan have been covered with siding, and the Colonial Revival buildings at 301 and 305 E. Michigan now have out-of-period Greek Revival porticos. The District's single Bungalow, smaller in scale than most other buildings, is one of the City's finest examples of the style (photo #18).

The 1876 William Davenport home (photos #11, 15, 16) faces these buildings, and occupies an entire city block on the south side of Michigan Avenue. It sits in a spacious landscaped lot, surrounded by a wooden fence. Two carriage houses, with slate-covered mansard roofs and elaborate bargeboards which match the Second Empire style of the main house, face E. Henry to the rear of the residence (see photos #14, 15). The similarly-styled Second Empire Beverly Davenport House at 302 E. Henry (1873, photo #17) sits behind the William Davenport home on the second-largest lot in the District. Although the building was covered with aluminum siding in the 1960s, salient stylistic features, such as bargeboards and fanciful dormers, remain intact, and along with the William Davenport home, it is a key visual landmark of both the District and the City as a whole.

**United States Department of the Interior
National Park Service**

**National Register of Historic Places
Inventory—Nomination Form**

For NPS use only

received

date entered

Continuation sheet

Item number

Page

The recently restored Queen Anne home at 217 E. Henry (c.1911) and the Italianate residence at 300 E. Henry (ca. 1870, photo #14) are included in the District because of their superior design qualities. The residential neighborhoods to the north, west, and south exhibit less architectural integrity and a higher percentage of intrusions, while the area to the immediate east begins the commercial strip along E. Michigan.

Inventory of Contributing Structures

William Davenport House, 300 E. Michigan (1876); Second Empire; William Scott of Detroit, architect; photos #11, 15, 16): two-and-one-half story frame construction resting on a high stone foundation; prominent features include tower and mansard slate roof with dormers. Two similarly detailed carriage houses sit to the south of the main residence (photo #15). The home was restored in 1935-37, including changes to the front porch and addition of a side porch. The residence is Saline's only property to be individually listed on the National Register.

BahnMiller Funeral Home, 301 E. Michigan (ca. 1910) Colonial Revival; Elwood Rogers, builder: a two-story clapboard building with rectangular window openings, shutters, and a one story brick addition to the west; remodeling includes an out-of-period two-story Greek Revival portico.

Max Fosdick House, 303 E. Michigan (1918); Bungalow; photo #18: a one-and-a-half story frame building with the roof ridge parallel to the street. A large full-pedimented dormer with twin rectangular windows projects from the roof above the full-width front porch. Classical brackets accent the overhang of the main roof and the dormer.

J. M. Rosse House, 305 E. Michigan (ca. 1900), Colonial Revival; a cross-gabled two-and-one-half story frame building with rectangular facade openings highlighted by pedimented architrave trim. A two-story out-of-period Greek Revival portico fronts the building. The May 6, 1909 Saline Observer describes the house on this site as the J. M. Rosse home. It is uncertain if Rosse built the home, or what he did for a living.

Samuel B. Weienett House, 307 E. Michigan (1909); Queen Anne; a two-and-one-half story frame building with a wraparound porch and shingle accents in the fully-pedimented gable ends. A barn with sliding doors stands to the rear of the residence. Samuel Weienett retired from farming and built this house on a lot purchased from Willis M. Fowler.

Residence, 309 E. Michigan (ca. 1900); transitional Queen

**United States Department of the Interior
National Park Service**

**National Register of Historic Places
Inventory—Nomination Form**

For NPS use only
received
date entered

Continuation sheet

Item number

Page

Anne-Colonial Revival: a cross-gabled two-and-one-half story frame building now covered with aluminum siding. Sunburst accents are still visible in the gable ends; a small barn is located to the rear of the home. The original owner is unknown. According to Arthur Miller, Aaron Armbruster occupied this house during the early 1900s.

Charles Woodridge House, 311 E. Michigan (1909); Queen Anne: a two-and-one-half story combination hipped and gabled roof frame building with a barn to the rear. Decorative features include shingle accents and a semi-circular window in the pedimented gable ends, and a pedimented full-width front porch with wrought iron railing. Charles Woodridge was a druggist. Date substantiated by deed records.

Steven T. Fairbanks House, 313 E. Michigan (1901); Queen Anne: a two-and-one-half story frame building now covered with siding except for shingle accents in the gable ends. A pedimented porch fronts the building; a hip-roofed side porch rests on a lattice-like base. Fairbanks ran a general store. Date substantiated by newspaper accounts.

Willis M. Fowler House, 315 E. Michigan (1911); Colonial Revival; Elwood Rogers, builder, photo #19: a two-and-one-half story frame building with a barn to the rear. The combination hipped and gabled roof is highlighted by semi-circular windows in the pedimented gable ends. A diamond-shaped second-story window and a wraparound porch add further architectural interest. Date substantiated by deed records.

Gay W. Harris House, 317 E. Michigan (1901); transitional Queen Anne-Colonial Revival: a two-and-one-half story frame building with barn to the rear. The projecting gables feature shingle accents and a Palladian window in the gable ends. The substantial wraparound front porch rests on a stone foundation. Gay Harris was a traveling salesman for Champion Harvesting and operated a wool warehouse next to the railroad tracks with Willis Fowler. Date substantiated by deed records.

Dwight Crittenden House, 319 E. Michigan (1911), transitional Queen Anne/Colonial Revival, Elwood Rogers, builder: a two-and-one-half story frame building, now sided, with a combination gabled and hipped roof. Second-story diamond windows add visual interest. The columns of the rounded wraparound porch rest on a modern brick base. Dwight Crittenden was a retired farmer. Date substantiated by newspaper accounts.

Mason/Hamlin House, 321 E. Michigan (ca. 1870); Vernacular: a two-and-one-half story frame building with overhanging eaves, a wide frieze, and a gabled roof. A partially-enclosed porch fronts the building and rests on a brick foundation. Alanson B. Hamlin purchased this lot from George and Ann Mason in 1908 for \$2700. The Mason's sold several lots in the

**United States Department of the Interior
National Park Service**

**National Register of Historic Places
Inventory—Nomination Form**

For NPS use only
received
date entered

Continuation sheet

Item number

Page

eastern part of this block, but it is highly probable that this house, which appears on the 1872 Bird's Eye View, is the oldest home on the north side of this block, and probably the oldest home in the District. The tax records for the period around 1870 show a Mial (?) Mason as owner of 5 acres on this site, historically located in Pittsfield Township.

Residence, 99 Maple (ca. 1920), photo #13; Vernacular; a two-and-one-half story frame building with gabled roof, shed dormer, and front porch with splayed columns. The building is covered with asphalt shingle and siding.

George Seeger House, 101 Maple (1911), Colonial Revival; Elwood Rogers, builder; photo #20: a two-and-one-half story frame building with a combination hipped and gabled roof and a gambrel roof barn to the rear. A curving wraparound porch with nicely tooled balusters fronts the home.

Henry Lindenschmidt House, 103 Maple (1911), transitional Queen Anne-Colonial Revival; Elwood Rogers, builder, photo #13: a two-and-one-half story frame house with a pedimented front porch resting on a dressed stone foundation. A frame barn is located to the rear. The June 11, 1911 Saline Observer describes the original owner as "Henry Lindenschmidt of Pittsfield" thus suggesting that he was not the Henry Lindenschmitt who operated a store in Saline and built the house at 202 E. Michigan. Date substantiated by newspaper accounts.

Frank E. Buck House, 217 E. Henry (ca. 1910-1912); Queen Anne: a recently restored two-story clapboard residence with projecting bay windows, a shed dormer with fan window, a wraparound front porch on a dressed stone foundation and a similarly detailed side porch. A barn sits to the north of the house. Date from owner abstract.

Residence, 300 E. Henry (ca. 1870s); Vernacular; a two-story frame building with gabled roof, projecting bay windows, shuttered rectangular windows with ornamental lintels and a hip-roofed front porch with tooled balusters. The building appears to be pictured on the 1872 Bird's Eye View.

Beverly Davenport House, 302 E. Henry (1873); Second Empire; J.J. Smith of Detroit, architect; photos #14, 17): a two-and-one half story frame house which features a mansard roof, unique squared front bay, decorative bargeboard trim, and projecting dormers. The original tower and front porch was removed in 1945, while the removal of the roof slate and application of aluminum siding occurred in the 1960s.

**United States Department of the Interior
National Park Service**

**National Register of Historic Places
Inventory—Nomination Form**

For NPS use only

received

date entered

Continuation sheet

Item number

Page

8. Significance: period--1800-1899; 1900--
 areas of significance--architecture, commerce
 specific dates--1870s-1920
 architects/builders--William Scott, J.J. Smith,
 Elwood Rogers, and unknowns

The East Michigan Avenue Historic District derives its significance from its cluster of large, nicely detailed Queen Anne and Colonial Revival homes (photos 11-13); the inclusion of one of the finest Bungalows in the City (photo #18); and the dominant presence of two outstanding visual landmarks in the Second Empire Davenport homes, both designed by Detroit architects in the 1870s (photo #s 14-17). Because of its outstanding architectural qualities and important historic associations with key property owners, the East Michigan Avenue Historic District remains a significant visual reminder of Saline's past, and is a particularly important feature of the contemporary city-scape due to the rapid commercialization of adjoining neighborhoods on E. Michigan Avenue.

Development in this part of Saline began in 1870 with the platting of the A.H. Risdon Addition. Like most Village expansion at the time, the new addition was a response to the increased activity caused by the arrival of the railroad. Although some construction took place following the platting, notably the Davenport homes and the house at 300 E. Henry, the properties north of E. Michigan remained largely undeveloped until 1900. The 1892 tax roll, the only volume extant for the post-1871 period, shows no construction on these sites. The burst of construction in the Queen Anne and Colonial Revival styles began after the turn of the century, on the George and Ann Mason lots, and lots purchased and then sold by Willis M. Fowler, who became involved in real estate at this time and built his own home at 315 E. Michigan in 1909.

William Davenport and his son, Beverly, original owners of the homes at 300 E. Michigan and 302 E. Henry respectively, were the most prominent of the local businessmen to make their homes in the District during the nineteenth century. The elder Davenport's commercial ventures included establishment of the Citizens Bank of Saline. Many of the District's residents were retired farmers who moved to town and took up new trades or local businessmen who built new homes after the turn of the century.

Pivotal Structures

303 E. Michigan (1917-18), photo #18
Max Fosdick House

Bungalows of high design quality were prevalent in early twentieth-

**United States Department of the Interior
National Park Service**

**National Register of Historic Places
Inventory—Nomination Form**

For NPS use only

received

date entered

Continuation sheet

Item number

Page

century Saline. While many City bungalows have been altered over the years, the continuously Fosdick-family-owned home remains an outstanding example of the style due to its purity and integrity of design. The one-and-a-half story frame building features a roof ridge parallel to the street which sweeps to enclose a one-story full-width front porch supported by four columns. The large full-pedimented dormer projects from the roof over the entrance and is accented by a porthole window and paired rectangular windows. Widely spaced, shallow classical brackets decorate the overhang of both roof and dormer. Max Fosdick, whose grandparents, Esther and Charlie, were farmers in Lodi Township, worked for Detroit Edison for 45 years.

315 E. Michigan (1911), photo #19
Willis M. Fowler House

One of five District homes constructed by local builder Elwood Rogers, this two-and-one-half story frame residence represents the high design quality of Rogers' Colonial Revival homes. Stylistic features include the squared wraparound porch, rectangular plan and a minimum of projecting bays. However, like most of Rogers' structures, the building also reveals lingering Queen Anne influences in its hipped roof, projecting gables, fan-shaped windows in the gable ends, and the distinctive diamond window placed above the off-center entrance. A large frame outbuilding with a broken pediment is located to the rear. Original owner William Fowler had a real estate business in Saline during the early decades of the twentieth century and also operated a wool warehouse along the railroad with Gay W. Harris.

101 Maple (early 1900s), photo #20
George Seeger House

Another frame home designed by Elwood Rogers, this nicely detailed two-and-one-half story Colonial Revival features a steeply pitched hipped roof with cross gables and broken pediments; square and rectangular window openings, and a one-story rear extension. A rounded wraparound porch fronts the home; its tooled balusters and stone-based columns rest on a raised stone foundation. A gambrel-roofed outbuilding is situated to the rear of the home. Original owner George Seeger was the son of prominent German American citizen and farmer, Matthias Seeger, holder of a number of local posts in Pittsfield Township. Seeger himself took over Charles Guthard's position in the hardware business with Henry Schroen. During the 1930s he operated a shoe repair and served as Fire Chief.

302 E. Henry (1873), photos #14, 17
Beverly Davenport House

United States Department of the Interior
National Park Service

National Register of Historic Places
Inventory—Nomination Form

For NPS use only

received

date entered

Continuation sheet

Item number

Page

Local businessman William Davenport hired Detroit architect J.J. Smith to design this lavish Second Empire home as a wedding gift for his son, Beverly. The younger Davenport had graduated from Detroit Commercial College in 1871 and joined his father in the mercantile trade around the time of the home's construction. Later he served as cashier and eventually president of the Citizens Bank founded by his father. During the 1890s Davenport planted 200 pear trees on his property. Orchards were common in the Saline area.

One of two Second Empire buildings in the City, the two-and-one-half story frame home is a key visual landmark and example of period despite the 1945 removal of its original tower and front porch, and the 1960s removal of the slate roof and installation of aluminum siding. The building's most distinctive feature is the central projecting bay with its flared gabled roof, squared-off top, and lacey bargeboard trim. The characteristic mansard roof is accented by porthole dormers and classically-detailed brackets below the eaves. A variety of window shapes add to the building's visual appeal.

300 E. Michigan (1876), photos #11, 15, 16
William Davenport House

Situated in the middle of an entire city block, the William Davenport House is the outstanding visual landmark of Saline, the pivotal structure of the District, and the only Saline building currently listed on the National Register. Detroit architect William Scott designed the imposing Second Empire Style structure with its slate mansard roof and matching carriage houses for Saline's most prominent late nineteenth century businessman, William H. Davenport.

In 1851, the New York-born Davenport entered into co-partnership with Henry J. Miller, keeper of a general store. Two years later he bought out Miller's interest and thus began a successful business career that included his own store and the establishment of the Citizens National Bank of Saline in 1855. The bank originated with Davenport keeping neighbors' surplus cash and valuables in his safe; eventually this sideline developed into a banking business. The bank became publicly owned in 1902 and still serves citizens of Saline. Davenport also organized the first volunteer fire brigade in 1875.

About 1875 Davenport hired William Scott to design a residence befitting his community position and family needs. During the same period Scott also constructed the Second Empire Wayne County Savings Bank, bringing to both buildings the grandeur of the au courant French design. Davenport's towering frame home was constructed of the finest materials.

United States Department of the Interior
National Park Service

National Register of Historic Places
Inventory—Nomination Form

For NPS use only

received

date entered

Continuation sheet

Item number

Page

It rests on a high cut stone foundation and features ornate brackets, corbels, lintels, dormers, and a prominent corner tower. Carved interior window cornices adorn the full length windows, while sculpted plaster decorates the high ceilings. The walnut, butternut, and maple trims remain unpainted. Over the years, the only interior alterations have been the addition of bathrooms and modernization of the kitchen. Two original carriage houses with slate mansard roofs and matching trim face E. Henry to the rear of the main residence. The home remained in the family after Davenport's death in 1909; then in 1930, family friend and bank employee, Carl A. Curtiss, inherited the house and restored it during the period 1935-37, adding a side porch and altering the original porch. The home is still owned by the Curtiss family.

9. Major Bibliographical Sources

(see General Bibliography section for full citation)

Chapman, History of Washtenaw County, 1881.

Deeds, various properties.

Ferry, W. Hawkins, The Buildings of Detroit (Detroit: Wayne State University Press), 1968.

Michigan State Gazetteers, 1911-12, 1917, 1932.

Ogle, Standard Atlas of Washtenaw County, 1895, 1915.

Portrait and Biographical Album, 1891.

Saline Historic District Commission Survey Notebook, 1975.

Saline Historic District Commission, Saline Has a Past in Its Future, 1976

Saline Observer, misc. issues, 1890-1912.

Walsh, Rita, 1979 draft of the Saline Multiple Resource Nomination and the William Davenport National Register Nomination.

10. Geographical Data

Acreage: approximately 16

Quadrangle Name: Saline

Quadrangle Scale: 1: 24,000

**United States Department of the Interior
National Park Service**

**National Register of Historic Places
Inventory—Nomination Form**

For NPS use only

received

date entered

Continuation sheet

Item number

Page

	A	17	270550	4672140
UTM References:	B	17	270800	4672240
	C	17	270890	4672040
	D	17	270700	4671880

Verbal boundary description: The East Michigan Avenue Historic District is bounded on the east by the west side of Maple street; on the south by the south side of E. Henry to the point of intersection with the east property line of 302 E. Henry, thence continuing along the rear property lines of 302 and 300 E. Henry; on the west by Davenport Street, but including the property at 217 E. Henry; and on the north by the rear property lines of 301, 303, 305, 307, 309, 311, 313, 315, 317, 319, and 321 E. Michigan and 99, 101, and 103 Maple.

Justification: As described in #7 above, these boundaries include the most significant and least altered historic homes in the threatened E. Michigan corridor which cluster around the key visual landmark of the William Davenport House at 300 E. Michigan. Surrounding areas, which contain commercial strips, new development, and a greater degree of intrusions and alterations, have been excluded in the interest of preserving District integrity.

United States Department of the Interior
National Park Service

National Register of Historic Places
Inventory—Nomination Form

For NPS use only
received 8/29/85
date entered

Continuation sheet

Item number

Page

Multiple Resource Area
Thematic Group

dnr-11

Name Saline MRA
State Washtenaw County, MICHIGAN

cover form accept P. Andrews 10/10/85

Nomination/Type of Review

Date/Signature

1. Annin, Joseph, House

Entered in the
National Register

✓ Keeper

Shelover Bryan 10/20/85

Attest

2. East Michigan Avenue
Historic District

Entered in the
National Register

✓ Keeper

Shelover Bryan 10/20/85

Attest

3. Forbes, Jortin, House

Entered in the
National Register

✓ Keeper

Shelover Bryan 10/20/85

Attest

4. Guthard, Charles, House

Entered in the
National Register

✓ Keeper

Shelover Bryan 10/20/85

Attest

5. Lutz, George R., House

Entered in the
National Register

✓ Keeper

Shelover Bryan 10/20/85

Attest

6. Miller--Walker House

Entered in the
National Register

✓ Keeper

Shelover Bryan 10/20/85

Attest

7. North Ann Arbor Street
Historic District

Substantive Review

✓ Keeper

accept Patrick Andrews 10/10/85

Attest

8. Oakwood Cemetery Mausoleum

Entered in the
National Register

✓ Keeper

Shelover Bryan 10/20/85

Attest

9. Saline First Presbyterian
Church

Entered in the
National Register

✓ Keeper

Shelover Bryan 10/20/85

Attest

10. Sturm, Louis, House

Entered in the
National Register

✓ Keeper

Shelover Bryan 10/20/85

Attest

NATIONAL REGISTER OF HISTORIC PLACES
EVALUATION/RETURN SHEET

Rec#
85002953

East Michigan Avenue Historic District (Saline
MRA)
Washtenaw County
MICHIGAN

Working No. AUG 29 1985
Fed. Reg. Date: 2-3-87
Date Due: 9/26/85 - 10/13/85
Action: ACCEPT 10-10-85
 RETURN
 REJECT
Federal Agency: _____

Entered in the
National Register

- resubmission
- nomination by person or local government
- owner objection
- appeal

Substantive Review: sample request appeal NR decision

Reviewer's comments:

Recom./Criteria _____
Reviewer _____
Discipline _____
Date _____
_____ see continuation sheet

Nomination returned for: _____ technical corrections cited below
_____ substantive reasons discussed below

1. Name

2. Location

3. Classification

Category	Ownership	Status	Present Use
	Public Acquisition	Accessible	

4. Owner of Property

5. Location of Legal Description

6. Representation in Existing Surveys

Has this property been determined eligible? yes no

7. Description

Condition		Check one	Check one
<input type="checkbox"/> excellent	<input type="checkbox"/> deteriorated	<input type="checkbox"/> unaltered	<input type="checkbox"/> original site
<input type="checkbox"/> good	<input type="checkbox"/> ruins	<input type="checkbox"/> altered	<input type="checkbox"/> moved date _____
<input type="checkbox"/> fair	<input type="checkbox"/> unexposed		

Describe the present and original (if known) physical appearance

- summary paragraph
- completeness
- clarity
- alterations/integrity
- dates
- boundary selection

8. Significance

Period _____ Areas of Significance—Check and justify below

Specific dates _____ Builder/Architect _____
Statement of Significance (*in one paragraph*)

- summary paragraph
- completeness
- clarity
- applicable criteria
- justification of areas checked
- relating significance to the resource
- context
- relationship of integrity to significance
- justification of exception
- other

9. Major Bibliographical References

10. Geographical Data

Acreage of nominated property _____
Quadrangle name _____
UTM References _____

Verbal boundary description and justification _____

11. Form Prepared By

12. State Historic Preservation Officer Certification

The evaluated significance of this property within the state is:

____ national ____ state ____ local

State Historic Preservation Officer signature _____

title _____ date _____

13. Other

- Maps
- Photographs
- Other

Questions concerning this nomination may be directed to _____

Signed _____ Date _____ Phone: _____



- a. Saline Multiple Resource Nomination
E. Michigan Ave. Historic District
(300 Block E. Michigan)
- b. Saline, Washtenaw Co., MI
- c. L. Sommers
- d. fall, 1984
- e. Mich. Bureau of History
208 N. Capitol
Lansing, MI
- f. facing E
- g. photo #11 of 40



6/2a

- a. Saline Multiple Resource Nomination
E. Michigan Historic District
(315-307 E. Michigan streetscape)
- b. Saline, Washtenaw Co., MI
- c. L. Sommers
- d. fall, 1984
- e. Mich. Bureau of History
208 N. Capitol
Lansing, MI
- f. facing NW
- g. photo #12 of 40



- a. Saline Multiple Resource Nomination
E. Michigan Ave. Historic District
(99-103 Maple)
- b. Saline, Washtenaw Co, MI
- c. L. Sommers
- d. fall, 1984
- e. Mich. Bureau of History
208 N. Capitol
Lansing, MI
- f. facing N
- g. photo #13 of 40



- a. Saline Multiple Resource Nomination
E. Michigan Ave. Historic District
(302-300 E. Henry)
- b. Saline, Washtenaw Co., MI
- c. L. Sommers
- d. fall, 1984
- e. Mich. Bureau of History
208 N. Capitol
Lansing, MI
- f. facing W
- g. photo #14 of 40



- a. Saline Multiple Resource Nomination
E. Michigan Ave. Historic District
(300 E. Michigan, William Davenport House)
- b. Saline, Washtenaw Co., MI
- c. L. Sommers
- d. fall, 1984
- e. Mich. Bureau of History
208 N. Capitol
Lansing, MI
- f. facing SE
- g. photo #16 of 40



- a. Saline Multiple Resource Nomination
E. Michigan Ave. Historic District
(302 E. Henry, Beverly Davenport House)
- b. Saline, Washtenaw Co., MI
- c. L. Sommers
- d. fall, 1984
- e. Mich. Bureau of History
208 N. Capitol
Lansing, MI
- f. facing S
- g. photo #17 of 40



51/11a

- a. Saline Multiple Resource Nom.
E. Michigan Historic District
(303 E. Michigan)
- b. Saline, Washtenaw Co., MI
- c. L. Sommers
- d. fall, 1984
- e. Mich. Bureau of History
208 N. Capitol
Lansing, MI
- f. facing NE
- g. photo #18 of 40



- a. Saline Multiple Resource Nom.
E. Michigan Ave. Historic District
(315 E. Michigan)
- b. Saline, Washtenaw Co., MI
- c. L. Sommers
- d. fall, 1984
- e. Mich. Bureau of History
208 N. Capitol
Lansing, MI
- f. facing NW
- g. photo #19 of 40



- a. Saline Multiple Resource Nom.
E. Michigan Ave. Historic District
(101 Maple)
- b. Saline, Washtenaw Co., MI
- c. L. Sommers
- d. fall, 1984
- e. Mich. Bureau of History
208 N. Capitol
Lansing, MI
- f. facing NW
- g. photo #20 of 40

Missing Core Documentation

Property Name	Multiple Property Name	Reference Number
East Michigan Avenue Historic District	Saline MRA	85002953

The following Core Documentation is missing from this entry:

___ Nomination Form

x Photographs (Photograph 15)

Please refer to the map in the
Multiple Property Cover Sheet
for this property

Multiple Property Cover Sheet Reference Number: 64000333

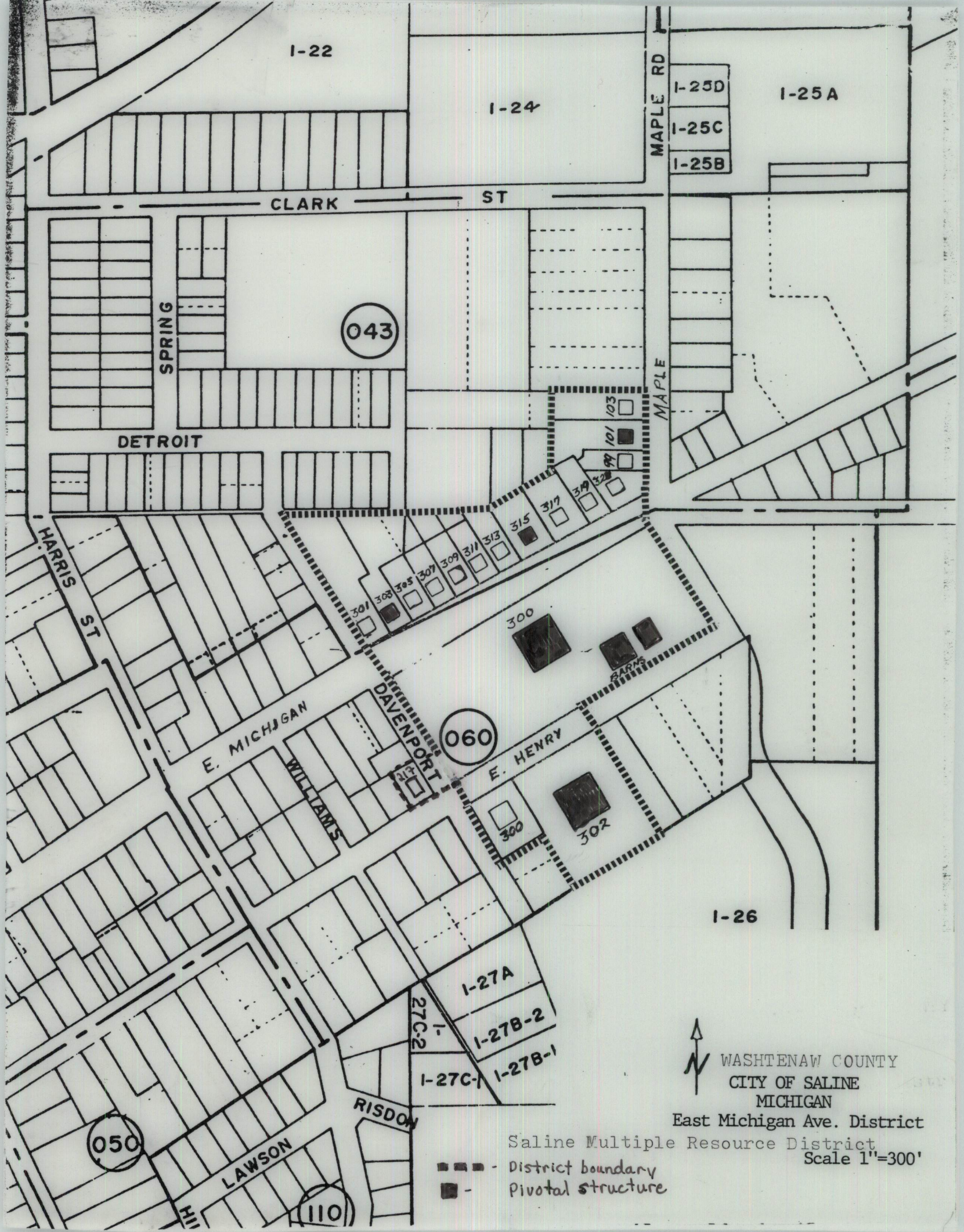

I-22

I-24

I-25D

I-25A

I-25C

I-25B

CLARK ST

SPRING

043

DETROIT

MAPLE

HARRIS ST

DAVENPORT

060

E. MICHIGAN

WILLIAMS

E. HENRY

I-26

I-27A

I-27B-2

I-27C-1

I-27B-1

27C-2

RISDON

LAWSON

050

110

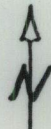

WASHTENAW COUNTY
CITY OF SALINE
MICHIGAN

East Michigan Ave. District

Saline Multiple Resource District
Scale 1"=300'

- District boundary
- Pivotal structure

DENNIS + PAULA MICHALAK
307 E. MICHIGAN AVE.
SALINE, MICHIGAN
48176

Dr. Martha M. Bigelow
State Historic Preservation Officer
Bureau of History
Michigan Department of State
Lansing, Mi. 48918

JUL 16 1985
JUL 15 1985

✓
recorded
and sent
8-7-16-85

7-11-85

Dear, Dr. Bigelow,

Please let it be known that Dennis J. and Paula J. Michalak, owners of 307 E. Michigan Ave. Saline, Michigan, do not wish the property to be listed with the National Register of Historic Places.

This letter is a formal objection to submitting 307 E. Michigan Ave. into the National Register of Historic Places, at least for now.

If you have questions or need further information please feel free to call on me at your convenience.

313 429-1325.

Thank You.
Dennis J. Michalak